



# Mini Expression Pedal Owner's Manual

Thanks for purchasing the DOD® Mini Expression Pedal, the miniature passive expression pedal that gives you a full range of expressive control, without robbing you of valuable pedalboard space.

## Features:

- Small form factor occupies minimal pedalboard space
- Long-throw treadle for full range of control
- High-quality, high-cycle 25k $\Omega$  potentiometer for smooth expressive control
- Impedance switch changes from 25k $\Omega$  (top/bottom) to 10k $\Omega$  (middle) to accommodate Line 6®-style CC inputs
- Removable rubber feet for pedalboard mounting
- 1/4" jack with selectable TS, TRS, or RTS operation
- Skid-free treadle pad
- Rugged construction

## Setup:

1. Connect your cables (see connection diagram below).
2. Select the correct cable connection setting (TS, TRS, or RTS) for the device you wish to control. (See the owner's manual for the controlled device to determine the proper setting.)
3. Push the DOD Mini Expression Pedal's treadle toe down.
4. Configure the controlled device for the desired type of expression control.

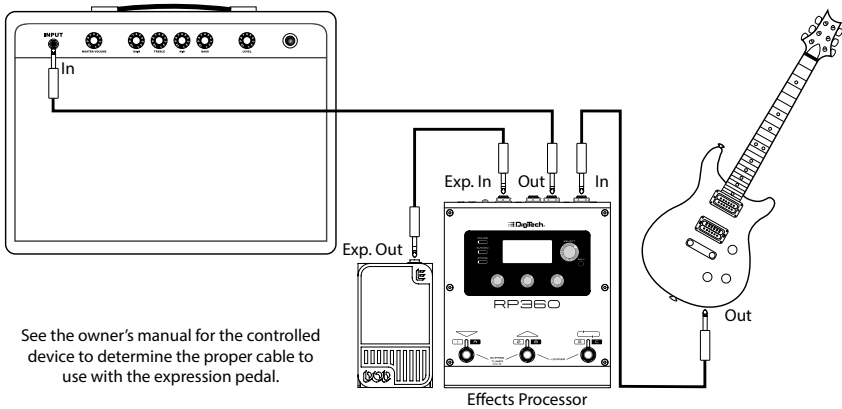

### \*\*\*IMPORTANT USAGE NOTE\*\*\*

The two hex screws on the bottom of the pedal are part of a spring-loaded adjustment mechanism. If over time you experience slop, loosen these screws slightly and then re-tighten. This will cause the main engagement gear to re-tighten against the treadle gear.

DO NOT remove these screws or operate the treadle while the screws are loosened. This can cause the gears to become misaligned and cause the pedal to malfunction. There are no user-adjustable components inside the pedal. Under no circumstances should the pedal be opened up.

## DECLARATION OF CONFORMITY

Manufacturer's Name: DOD  
Manufacturer's Address: 10653 South River Front Parkway, #300  
South Jordan, Utah 84095, USA

Declares that the product:

Product name: DOD Mini-Expression  
Product option: None

Conforms to the following Product Specifications:

Safety: N/A – no power  
EMC: Analog Products

The DOD Mini-Volume and Mini-Expression pedals by design provide an adequate level of intrinsic immunity as called out in EN55024. By following good engineering practices and engineering rational Harman declares that by design these pedals will provide an adequate level of intrinsic immunity and will operate as intended in their environment.

Supplementary Information:

The product herewith complies with the requirements of the:  
Low Voltage Directive 2006/95/EC  
EMC Directive 2004/108/EC  
RoHS Directive 2011/65/EC  
WEEE Directive 2002/96/EC  
EC Regulation 278/2009

C. Rex Reed  
Director, Engineering  
Signal Processing  
10653 South River Front Parkway, #300  
South Jordan, Utah 84095, USA  
Date: June 26, 2017

European Contact: Your local DigiTech Sales and Service Office or

Harman Signal Processing  
10653 South River Front Parkway, #300  
South Jordan, Utah 84095, USA  
Ph: (801) 566-8800  
Fax: (801) 568-7583

## DÉCLARATION DE CONFORMITÉ

Nom du fabricant : DOD  
Adresse du fabricant : 10653 South River Front Parkway, #300  
South Jordan, Utah 84095, ÉTATS-UNIS

déclare que le produit :

Nom du produit : DOD Mini-Expression  
Option du produit : Aucune

est conforme aux spécifications suivantes :

Sécurité : S/O – sans pouvoir  
CEM : Produits Analogiques

Les pédales DOD Mini-Volume et Mini-Expression par conception fournissent un niveau adéquat d'immunité intrinsèque tel qu'indiqué dans EN55024. En suivant les bonnes pratiques d'ingénierie et l'ingénierie rationnelle, Harman déclare que, grâce à la conception, ces pédales fourniront un niveau adéquat d'immunité intrinsèque et fonctionneront comme prévu dans leur environnement.

Informations complémentaires :

Ce produit est conforme aux exigences suivantes :  
Directive sur la basse tension 2006/95/CE  
Directive CEM 2004/108/CE  
Directive RoHS 2011/65/CE  
Directive DEEE 2002/96/CE  
Règlement 278/2009 de l'CE

C. Rex Reed  
Directeur, Ingénierie  
Traitement des signaux  
10653 South River Front Parkway, #300  
South Jordan, Utah 84095, ÉTATS-UNIS  
Date : 26 juin 2017

Contact en Europe : Votre bureau local de vente et de service DigiTech ou

Harman Signal Processing  
10653 South River Front Parkway, #300  
South Jordan, Utah 84095, ÉTATS-UNIS  
Tél. : (801) 566-8800  
Fax : (801) 568-7583